

Free-standing luminaire

TYCOON LED - DYS 504/D 121649000-00556549



450€

Free-standing Luminaire

ATARO - DUS 440/R 121223002-00057965



400€

Free-standing luminaire

LAVIGO - DPS 372/R 121707000-00630732



450€

Free-standing luminaire

LAVIGO - DPS 240/R 121713000-00630750



400€

Free-standing luminaire LAVIGO - DPS 288/P

121709000-00707139 replaces 121709000-00635021



450€



fitted with

work equipment
connected load
power consumption
luminous flux
luminous efficacy
light distribution
direct ratio
light colour
Color Rendering Index (CRI)
consistent white light of
glare-free
luminance
unified glare rating
technology
usage
luminaire body
lamp cover
tubular section
luminaire base
weight (net)
mains lead

4 x LED module
 Energy efficiency category A+
 4 x LED module
 Energy efficiency category A+
 power supply unit
 220-240V; 50/60Hz
 approx. 86 W
 approx. 9250 lm
 approx. 108 lm/W
 direct/indirect
 approx. 34 %
 neutral white, approx. 4000 K
 > 80
 < 3 SDCM
 conical prismatic screen
 < 2700 cd/m²
 < 16
 continuously dimmable
 multi-function switch
 aluminium/plastic, painted, white
 acrylic clear
 steel tube, painted, tubular section offset, white
 C-form flat
 approx. 20.5 kg
 approx. 3,0 m; mains plug
 CEE 7/VI
 floor standing base
 luminaire head detachable, head connection can be turned in an angle of $\pm 45^\circ$, LED light engine according to Zhaga standard, luminaire head can be turned in an angle of $\pm 90^\circ$, light forming, separated; direct and indirect light individually adjustable

fastening
special features



CEE 7/VI

luminous intensity

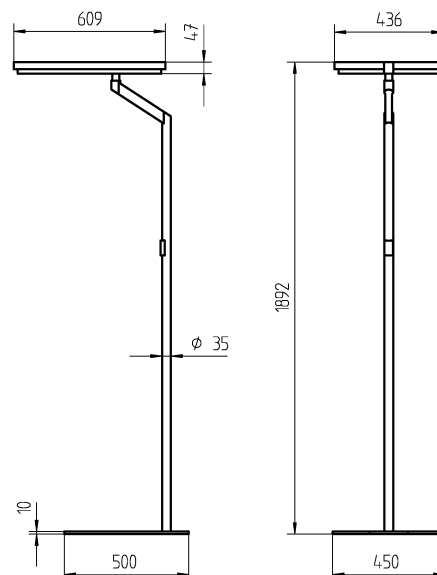
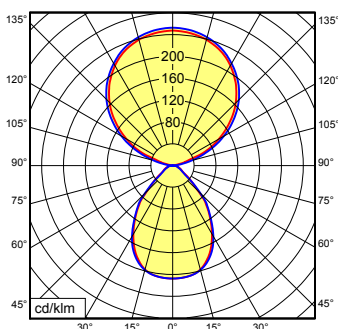

Free-standing Luminaire

ATARO - DUS 440/R 121223002-00057965

Waldmann **W**

ENGINEER OF LIGHT.



fitted with

4 x compact fluorescent lamp TC-LEL 40W/840 2G11
light colour neutral white, 4000 K, Color Rendering Index (CRI)=80

work equipment

Energy efficiency category A
electronic ballast dimable digital
Energy efficiency index (EEI): A1 BAT

connected load

220-240V; 50/60Hz

power consumption

approx. 165 W

light distribution

mainly indirect

luminaire efficiency

approx. 74 %

Light yield

approx. 62 lm/W

glare-free

structured screen

technology

presence and daylight dependant controlled, continuously dimmable
multi-function switch

usage

luminaire body

material

aluminium

surface

anodised

colour

aluminium coloured anodised

lamp cover

not permitted, without

tubular section

material

steel tube

surface

painted

Form

tubular section upright

colour of tubular section

silver metallic

luminaire base

Form

C-form flat

weight (net)

approx. 21.3 kg

mains lead

approx. 3.0 m; shock-proof plug

fastening

floor standing base

special features

reflector detachable, head connection can be turned in an angle of $\pm 45^\circ$

distribution of luminous intensity

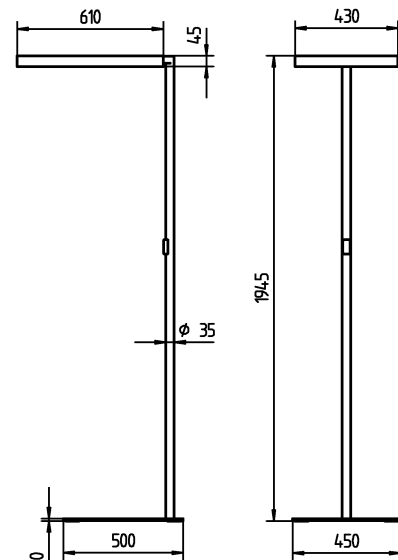
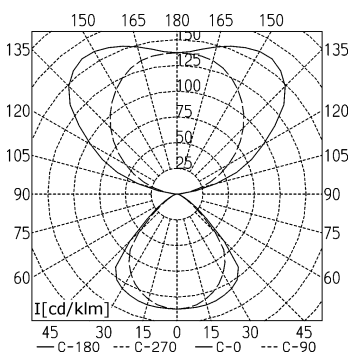



fitted with

work equipment
connected load
power consumption
power factor
luminous flux
light yield
light distribution
direct ratio
light colour
Color Rendering Index (CRI)
consistent white light of

3 x LED module
 Energy efficiency category A+
 2 x LED module
 Energy efficiency category A+
 power supply unit
 220-240V; 50/60Hz
 approx. 104 W
 approx. 0,966
 approx. 12000 lm
 approx. 115 lm/W
 direct/indirect
 approx. 15 %
 neutral white, approx. 4000 K
 > 80
 < 3 SDCM

glare-free
luminance
unified glare rating
technology
usage
luminaire body
lamp cover
tubular section
luminaire base
weight (net)
mains lead

conical prismatic screen
 < 2500 cd/m²
 < 16
 presence and daylight sensor control (PIR)
 multi-function switch
 steel/plastic, painted, white
 acrylic clear
 steel tube, painted, tubular section upright, white
 C-form flat
 approx. 18.5 kg
 approx. 3,0 m; mains plug
 CEE 7/II

fastening
decorative contrast side parts
special features

floor standing base
 flint grey
 luminaire head detachable, integrated light and presence sensor PULSE PIR, LED light engine according to Zhaga standard, light forming, retrofit with EnOcean wireless module PULSE-TALK, separated; direct and indirect light individually adjustable



CEE 7/II

luminous intensity

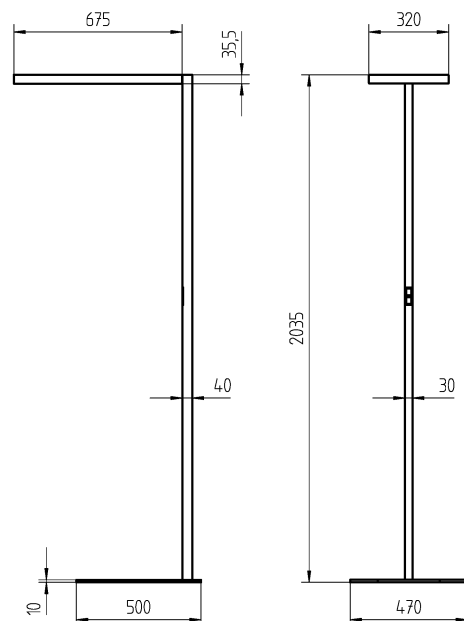
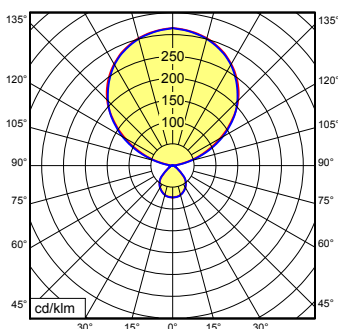



fitted with

work equipment
connected load
power consumption
power factor
luminous flux
light yield
light distribution
direct ratio
light colour
Color Rendering Index (CRI)
consistent white light of

2 x LED module
 Energy efficiency category A+
 2 x LED module
 Energy efficiency category A+
 power supply unit
 220-240V; 50/60Hz
 approx. 49 W
 approx. 0,966
 approx. 5700 lm
 approx. 116 lm/W
 direct/indirect
 approx. 30 %
 neutral white, approx. 4000 K
 > 80
 < 3 SDCM
 conical prismatic screen
 < 2500 cd/m²
 < 16
 presence and daylight sensor control (PIR)
 multi-function switch
 steel/plastic, painted, white
 acrylic clear
 steel tube, painted, tubular section upright, white
 C-form flat
 approx. 18.5 kg
 approx. 3,0 m; mains plug
 CEE 7/II

glare-free
luminance
unified glare rating
technology
usage
luminaire body
lamp cover
tubular section
luminaire base
weight (net)
mains lead

fastening
decorative contrast side parts
special features

floor standing base
 flint grey
 luminaire head detachable, integrated light and presence sensor PULSE PIR, LED light engine according to Zhaga standard, light forming, retrofit with EnOcean wireless module PULSE-TALK, separated; direct and indirect light individually adjustable



CEE 7/II

luminous intensity

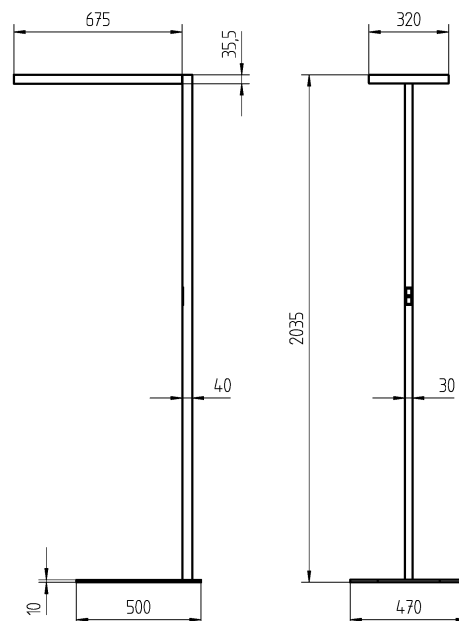
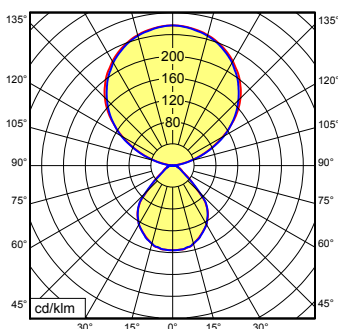



fitted with

- work equipment**
- connected load**
- power consumption**
- power factor**
- luminous flux**
- luminous efficacy**
- light distribution**
- direct ratio**
- light colour**
- color rendering index (CRI)**
- consistent white light of**
- glare-free**
- luminance**
- unified glare rating**
- technology**
- usage**
- luminaire body**
- lamp cover**
- tubular section**
- luminaire base**
- weight (net)**
- mains lead**

LED

- Energy efficiency category A++
- electronic ballast
- 220-240V; 50/60Hz
- approx. 62 W
- approx. 0,966
- approx. 8600 lm
- approx. 139 lm/W
- direct/indirect
- approx. 20 %
- neutral white, approx. 4000 K
- > 80
- < 3 SDCM
- conical prismatic screen
- < 2500 cd/m²
- < 16
- controlled depending on presence and daylight
- multi-function switch
- steel/plastic, painted, silver metallic
- polycarbonate, clear
- steel tube, painted, tubular section upright, silver metallic
- C-form flat
- approx. 18.5 kg
- approx. 3,0 m; mains plug
- CEE 7/VII
- floor standing base
- brilliant silver
- luminaire head detachable, integrated light- and presence-detecting sensor PULSE, LED light engine according to Zhaga standard, light forming, retrofit with EnOcean wireless module PULSE-TALK, separated; direct and indirect light individually adjustable

- fastening**
- decorative contrast side parts**
- special features**



CEE 7/VII

luminous intensity

